

THE ARMADILLO™

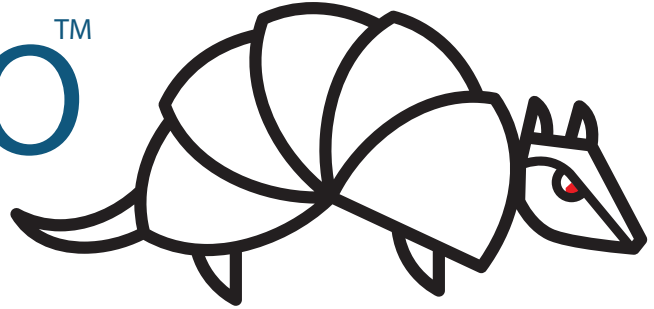

RUGGEDIZED WATERPROOF CAMERA



Features

2,000psi Pressure Rating

Ruggedized to Resist Extreme Wear and Abuse

Digital Wide-Angle Image

Used In Tunnel Boring Machines, Subsea ROVs, Pipe Inspection
Vehicles, and Other High Pressure Extreme Environment Applications

Steady
flux

THE ARMADILLOTM

MECHANICAL SPECIFICATIONS

Housing	316 Stainless Steel
Outer Lens	Sapphire
LED Port Material	Fused Silica
Outer Diameter	0.990 in (25 mm)
Overall Length	2.2 in (56 mm)

ENVIRONMENTAL SPECIFICATIONS

Pressure Rating	2000 psi (140 bar)
Operating Temp	10 deg F to 120 deg F (-12 deg C to 49 deg C)

OPTICAL SPECIFICATIONS

Focus	Fixed focus, Factory Set
FOV	90 deg

VIDEO SPECIFICATIONS

Image Sensor	Single chip 1/3 CMOS
Resolution	NTSC 656 X 492 PAL 796 X 576
Video Output	1.0V peak to peak into 75ohm
Video Format	NTSC or PAL
Lighting	5 Phillips LEDs

ELECTRICAL SPECIFICATIONS

Camera Voltage	12 VDC
Camera Current	100mA
LED Voltage	15 VDC
LED Current	160mA

Dimensions

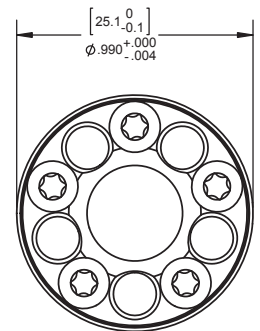
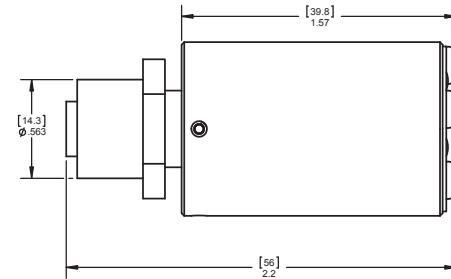

NOTES:

- CAMERA PLUG NOT RATED FOR PRESSURE
- LED CURRENT MUST NOT EXCEED 160 mA
- CUSTOM PLUG OPTIONS AVAILABLE